

The Glendale

A Home Perfected by Denim Homes



The Glendale

through the laundry room.

This attractive plan is an ideal design for a couple just starting out, or for couples whose children has left home and want to scale down the size of their home. The one-floor plan contains all the features and rooms for comfortable living and offers a generous living space of more than 1,400 square feet. The raised entrance is flanked by stone-accented pillars and the porch is both welcoming and a practical cover for visitors who arrive in the rain. From the foyer, French doors open to the den, a good-sized room that could be designated for other purposes, if desired. A young couple might want to convert this useful bonus room to a third bedroom, or a mature couple could use the room as sewing or hobby room. The two bedrooms also face the back garden. The master suite has a walk-in closet and an en suite bathroom with a shower enclosure. The second bedroom has an adjoining three-piece bathroom. The double-car garage has a side-door entrance and provides entry into the house

1403 Square Feet

**3 Bedrooms
2 baths**





Denim Homes

Caleb Howden
31 Falcon Dr
Kentville NS
(902) 698-2478
Fax: (902) 482-3442
www.denimhomes.com

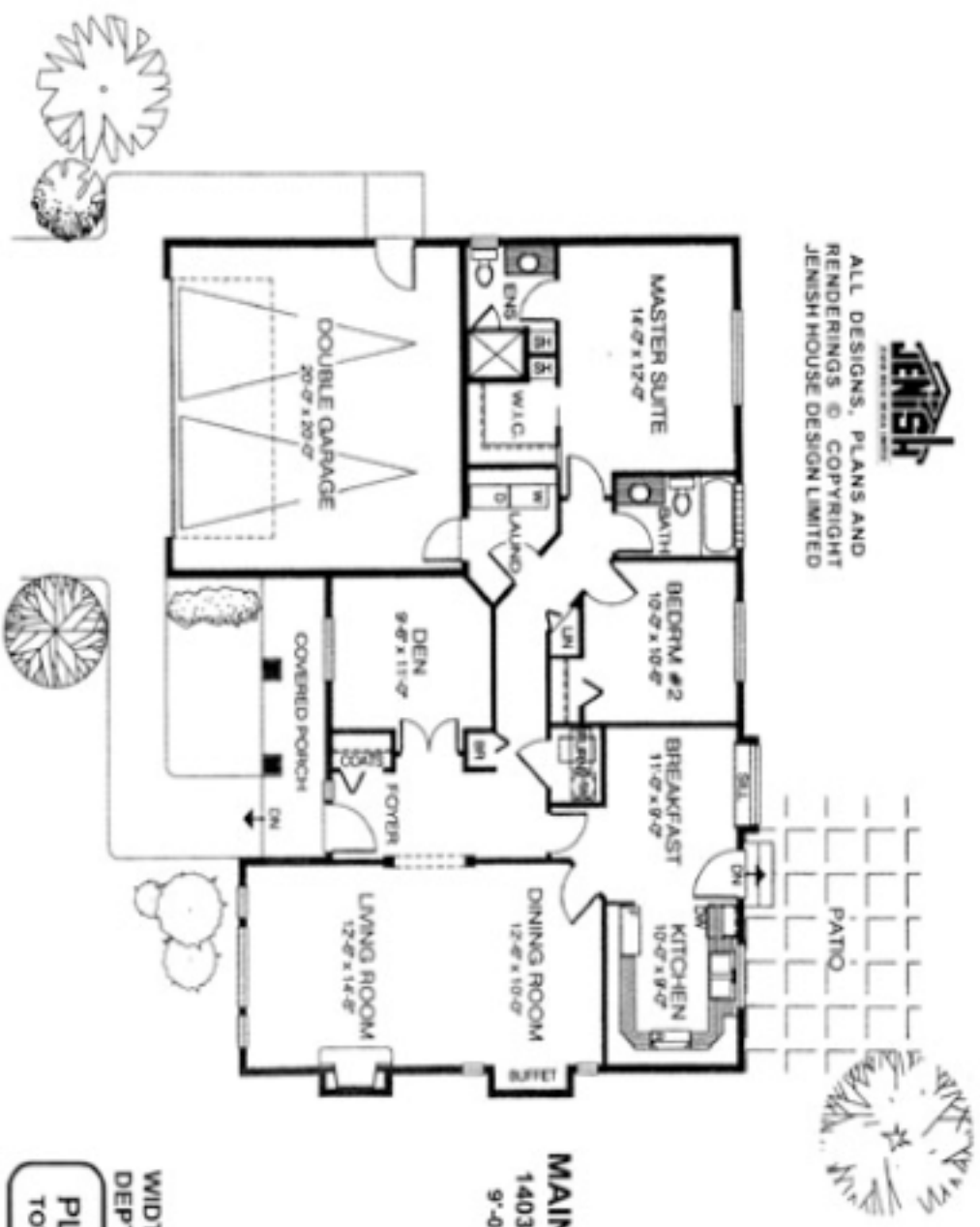

ALL DESIGNS, PLANS AND
RENDERINGS © COPYRIGHT
JENISH HOUSE DESIGN LIMITED



MAIN FLOOR PLAN
1403 SQ. FT. (130.3 M²)
9'-0" CEILING HEIGHT

WIDTH - 52'-0" (15.8M)
DEPTH - 40'-0" (12.2M)
PLAN NO. H5-3-631
TOTAL 1403 SQ. FT. (130.3 M²)